

Speed meets outstanding accuracy

ROBOCUT α -CiC series - Multipurpose Wire EDM



**PREVENTION
OF WIRE BREAK
THROUGH SIMPLE
ADJUSTMENTS**



**TAPER ADJUSTMENT
FUNCTION FOR HIGH
PRECISION TAPER CUTTING**



**AUTOMATIC WIRE FEEDING
UP TO 500 MM UNDER
SUBMERGE CONDITION**



**STRONG MACHINE
RIGIDITY FOR HIGH
PERFORMANCE CUTTING**



Designed for ultimate performance

- high speed, high precision and high quality cutting thanks to steady mechanical structure and excellent discharge devices and control
- stable cutting and easy adjustment of shapes through AI thermal displacement compensation function
- designed for continuous unmanned machining thanks to highly reliable automatic wire feeding (AWF3)
- simple and routine maintenance to reduce your downtime
- high-precision rotary table ROBOCUT CCR opens up new opportunities for your applications
- production and quality information management provided by ROBOCUT-LINKi to optimise your performance

Technical data

Standard		α -C400iC	α -C600iC	α -C800iC
Maximum workpiece dimensions [mm] without automatic door	Z axis travel standard	730 x 630 x 250	1050 x 820 x 300	1250 x 975 x 300
	Z axis travel option	-	1050 x 820 x 400	1250 x 975 x 500
Maximum workpiece dimensions [mm] With automatic door	Z axis travel standard	730 x 585 x 250	1050 x 775 x 300	1250 x 975 x 300
	Z axis travel option	-	1050 x 775 x 400	1250 x 975 x 500
Maximum workpiece mass [kg]		500	1000	3000
XY axis table travel [mm]		400 x 300	600 x 400	800 x 600
Z axis table travel [mm]	Standard	255	310	310
	Option	-	410	510
UV axis table travel [mm]		$\pm 60 \times \pm 60$	$\pm 100 \times \pm 100$	$\pm 100 \times \pm 100$
Maximum taper angle [mm]	Standard	$\pm 30^\circ / 80$	$\pm 30^\circ / 150$	$\pm 30^\circ / 150$
	Option	$\pm 45^\circ / 40$	$\pm 45^\circ / 70$	$\pm 45^\circ / 70$
Wire diameter [mm]	Standard	$\varnothing 0.10 \sim \varnothing 0.30$		$\varnothing 0.10 \sim \varnothing 0.30$
	Option	$\varnothing 0.05 \sim \varnothing 0.30$	-	
Maximum wire mass [kg]		16		30
Machine mass excluding dielectric medium [kg]		About 2200	About 3600	About 5300
Controller		FANUC Series 31i-WB		

Outer dimension | Floor plan

ROBOCUT α - C600iC



ROBOCUT α - C400iC



ROBOCUT α - C800iC

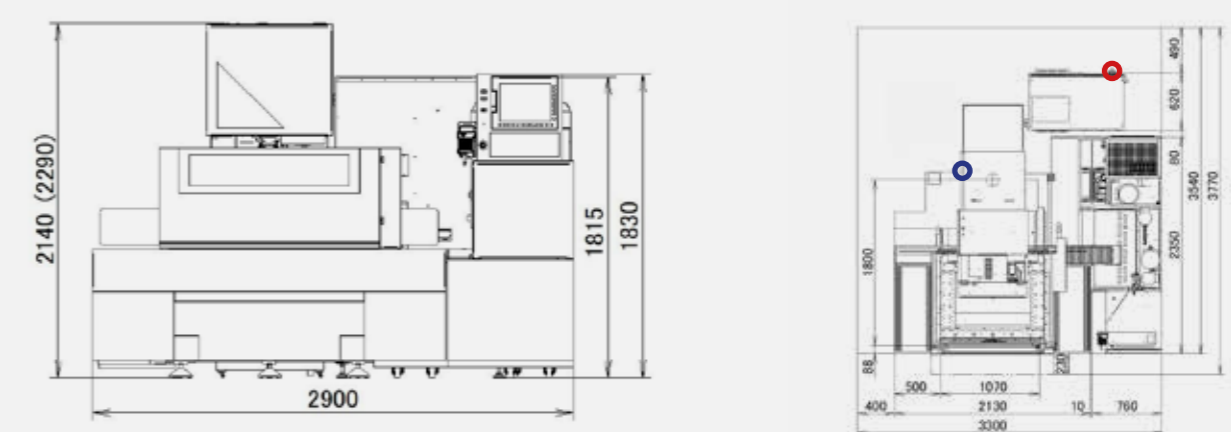

- Power input position
- Compressed air input position
- * The values in parentheses $\langle \rangle$ are when the safety cover is open.

*] The above floor plan is that of a standard type machine. Contact FANUC if you wish to order options such as Z axis travel 410 mm, 510 mm and 30 kg wire loader options.

One common servo and control platform – Infinite opportunities THAT's FANUC!



FA
CNCs,
Servo Motors
and Lasers

ROBOTS
Industrial Robots,
Accessories
and Software

ROBOCUT
CNC Wire-Cut
Electric Discharge
Machines

ROBODRILL
Compact
CNC Machining
Centres

ROBOSHOT
Electric CNC
Injection Moulding
Machines

IoT
Industry 4.0
solutions