

ROBOCUT α -C600iC Mechanical specifications



Standard	
Maximum workpiece dimensions [mm]	1050 × 820 × 300
Maximum workpiece weight [kg]	1000
XY axis table travel [mm]	600 × 400
Z axis travel [mm]	310
UV axis travel [mm]	± 100 × ±100
Maximum taper angle [°/mm]	±30/150
Minimum step increment of the drives [mm]	0,0001
Wire diameter [mm]	Ø 0.10 ~ Ø 0.30
Maximum wire weight [kg]	16
Machine weight (approx.) [kg]	About 3600
Controller	FANUC 31i-WB
Part program storage size [MB]	8
Acoustic noise level	
LPA [dB]	64
LPCpeak [dB]	81
Optional	
Z axis 400	
Z axis travel [mm]	410
Maximum workpiece dimensions without automatic door, option Z axis travel [mm]	1050 × 820 × 400
Automatic front door	
Maximum workpiece dimensions [mm]	1050 × 775 × 300
45° die guide	
Maximum taper angle [°/mm]	± 45/ 70
30 kg wire feed unit	
Maximum wire weight [kg]	30

Installing conditions	
Power supply	AC200V±10% 3-phase 50/60Hz ±1Hz, AC220V±10% 3-phase 60Hz ±1Hz, Connection cable terminal size: 8-5, Power consumption: 13kVA
Air supply	Air pressure: 0.5 – 0.7 MPa, Flow rate: 160L / min or more *Regulator-side coupler mounting screw: Rc1/4
Shield room	If discharge noise can interfere with surrounding radio, television and other sets, a shield room needs to be created.
Environment	Ambient temperature: 15-30°C, *Recommend 20±1°C for high precision machining. Install under the oil mist free and dust free environment. Humidity: 75% RH or less.
Grounding	400 mm or more are recommended as concrete foundation ground where machine is located to endure its weight. Ground should be selected where no vibration or no impact effect. As vibration level, the maximum amplitude should be 2 nm or less under frequency band from 10 to 20 Hz. The unit must be grounded to prevent damage resulting from electro-magnetic interference or electrical leakage. The unit is recommended to be installed so that the ground resistance is less than 10Ω. Also the grounding should be isolated from other machines.

α -C600iC Outer dimensions | Floor plan

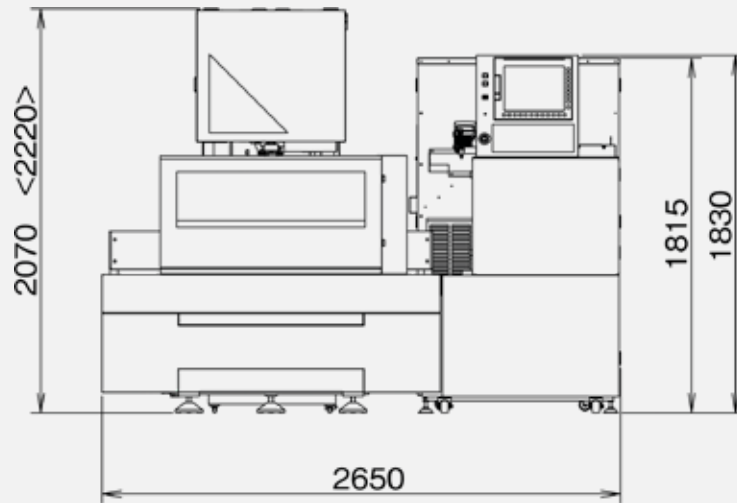

○ Power input position

○ Compressed air input position

*The values in parentheses < > are when the safety cover is open.

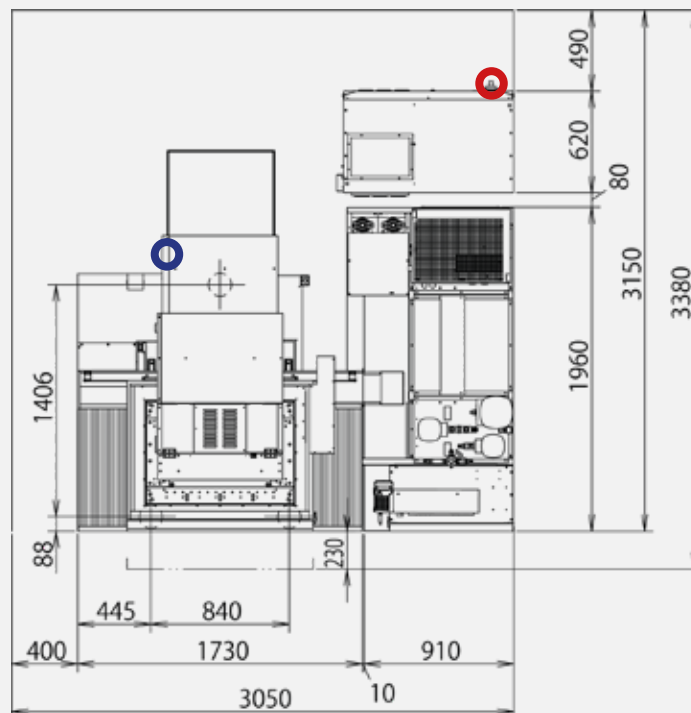

*) The above floor plan is that of a standard type machine.
Contact FANUC if you wish to order options such as 30 kg wire feed unit.

α -C600iC Outer dimensions | Floor plan (Z400 option)

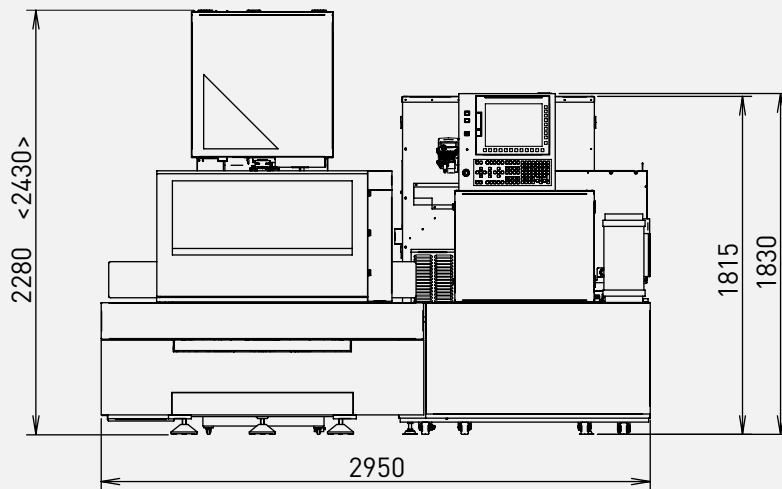

 Power input position

 Compressed air input position

*The values in parentheses < > are when the safety cover is open.

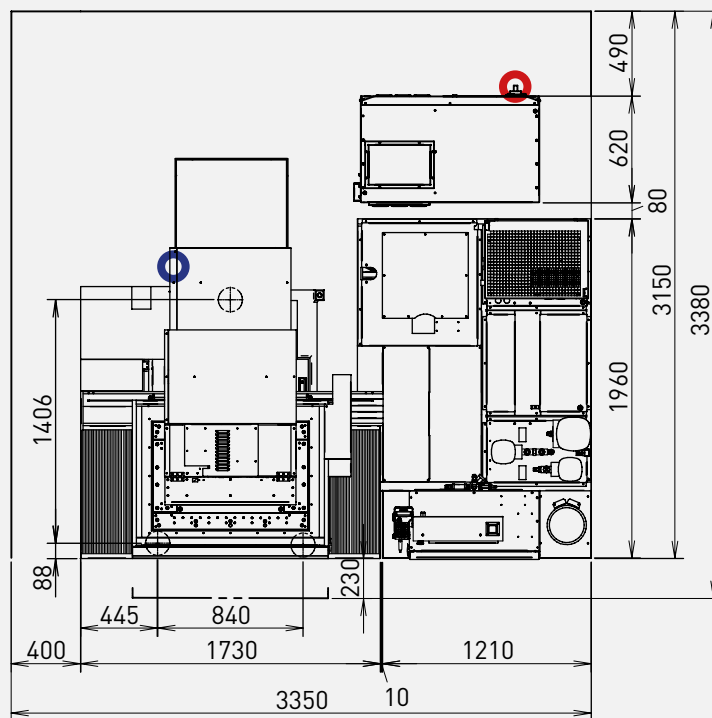

*) The above floor plan is that of a standard Z axis 400 type machine.
Contact FANUC if you wish to order options such as 30 kg wire feed unit.